

- 1=5/16 LOCKING PIN-A
- 5=5/16 LOCK NUTS-B
- 5=5/16 X 1 BOLTS-C
- 5=5/16 USS WASHERS-D
- 6=5/16 SAE WASHERS-E
- 2=1/4 X1 YELLOW SQUARE
- U-BOLTS-F
- 4=1/4 ROD CAPS-G
- 4=1/4 LOCK NUTS-H
- 4=1/4 SAE WASHERS-I



20047

UNIVERSAL REAR RACK MOUNTED GUN BOOT BRACKET.

MOUNT BRACKETS TOGETHER BEFORE MOUNTING TO THE REAR RACK.

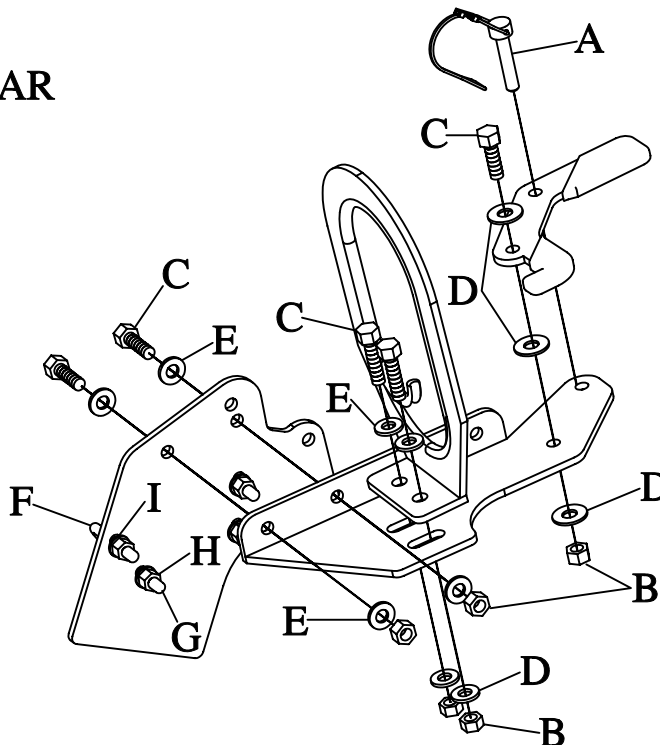

ONCE ALL PARTS HAVE BEEN ASSEMBLED THEN PROCEED TO MOUNT THE BRACKET TO THE REAR RACK.

OPTIONAL HOLES FOR DIFFERENT POSITIONS ON DIFFERENT MAKES AND MODELS.

