

STRONG SM MADE™

BY SAVANT MANUFACTURING, INC.

www.savantmfg.com

- 12=1/4 LOCK NUTS-A
- 4=1/4 SAE WASHERS-B
- 6=1/4X1 SQUARE YELLOW U-BOLTS-C
- 2=7/16 LOCK NUTS-D
- 4=7/16 SAE WASHERS-E
- 2=5/16X1 1/4 BOLTS-F
- 4=5/16 SAE WASHERS-G
- 2=7/16X2 1/4 BOLTS-H
- 2=5/16 LOCK NUTS-I
- 4=1/4 ROD CAPS-J
- 2=1" PLUGS-K
- 1= ALUMIN. WASHERS SLOTS-L
- 2=3/16X1 1/4X7/8 ROUND CLIPS-M
- 1=GR BRACKET L SHAPE-N
- 1= 1" TUB. 19 LONG-O
- 2=FGAR-2-P
- 1=MAIN BRACKET-Q

PACK IN BOX,

1=MAIN BRACKET-Q

4=RUBBER SNUBBERS-R

#GR121

HONDA 450S 450ES 500 RUB.

(MAIN BRACKET)

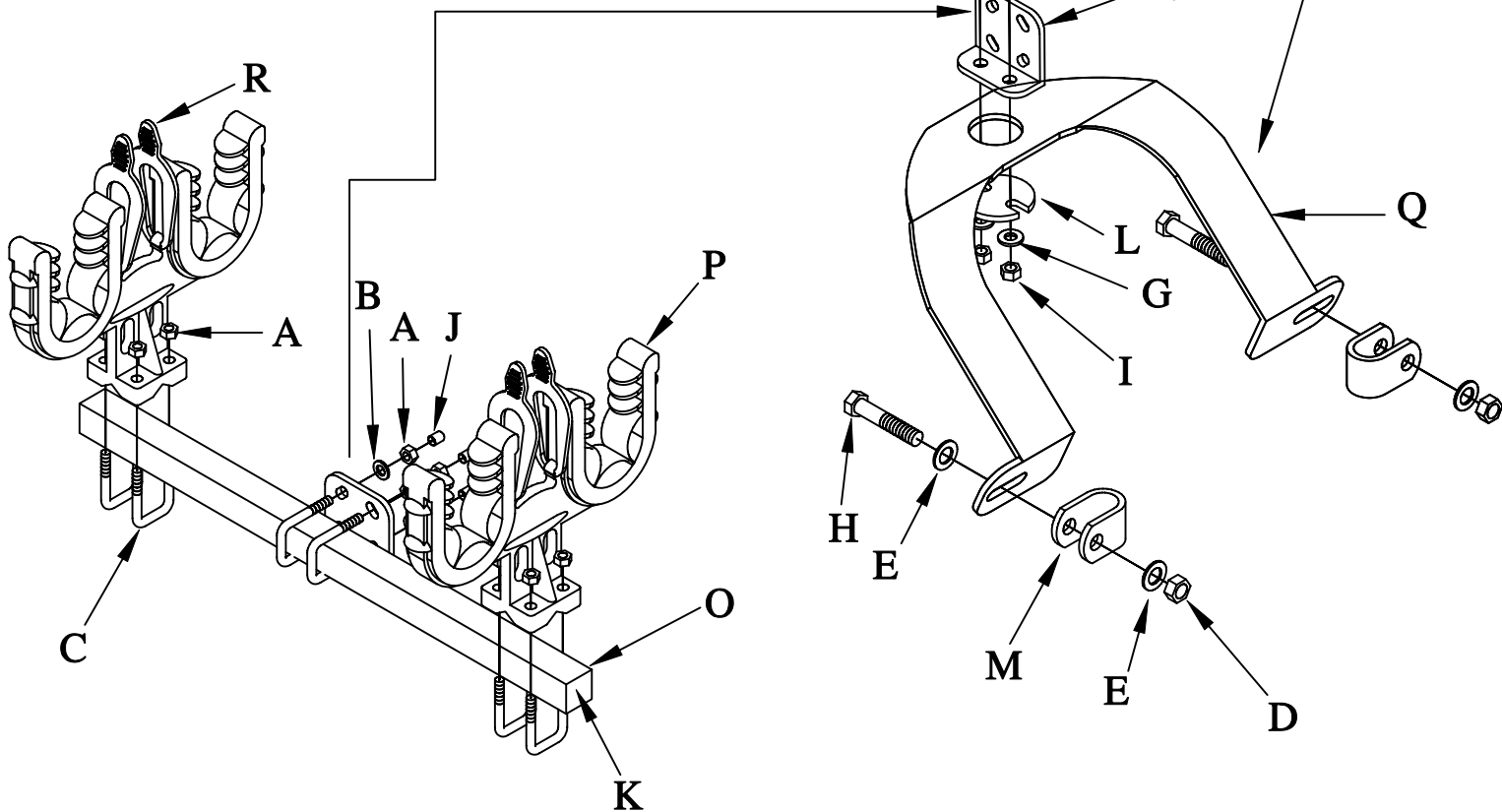

THE MAIN BRACKET WILL MOUNT ON TOP OVER THE HEAD LIGHT ON THE BARS AS THE PICTURE SHOWS.