

- 8=#16 TANNER RIVETS-A
- 8=5/16 SAE WASHERS-B
- 8=QC101 CLIPS-C
- 8=5/16 X 1 BOLTS-D
- 8= 3/16 X 1 X 3/16 ZINC ROUND WASHERS-E
- 8=5/16 USS WASHERS-F



SS205H

REAR GUARDS POLARIS
SPORTSMAN 550/850 2010

IT IS RECOMMENDED TO REMOVE THE WHEELS TO INSTALL THE GUARDS. ONCE INSTALLED REPLACE THE WHEELS IN REVERSE ORDER.

PLACE THE WASHERS AND RIVETS INTO THE HOLES OF THE PLATE THIS IS USED AS SPACERS FOR CLEANING PURPOSES.

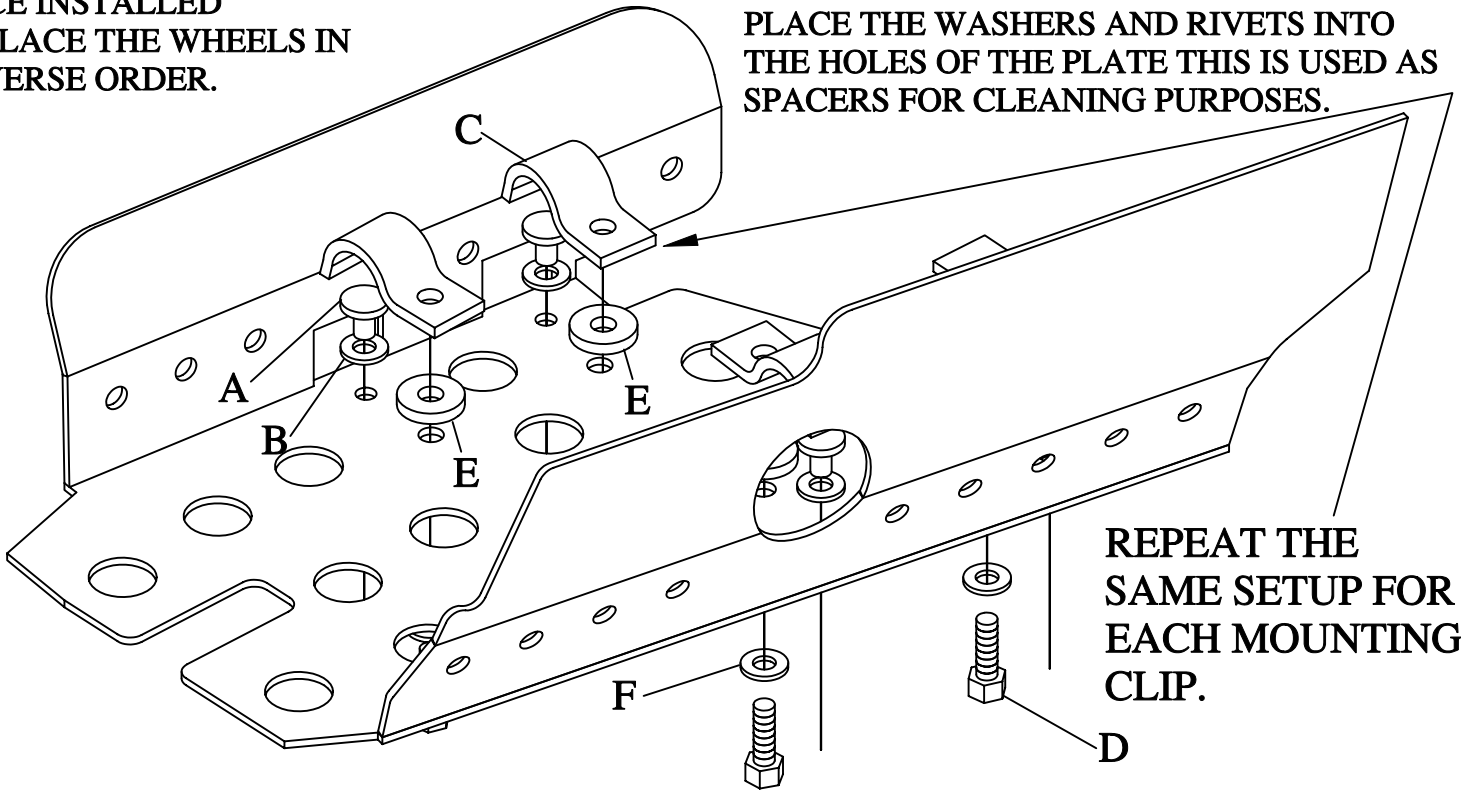

REPEAT THE SAME SETUP FOR EACH MOUNTING CLIP.

LEAVE ALL FASTENERS LOOSE UNTIL ALL HARDWARE IS IN PLACE THE PROCEED TO TIGHTEN TO PROPER SPECS.

