

- 2=1/4X1/2 U-BOLTS-A
- 4=1/4 LOCK NUTS-B
- 4=1/4 USS WASHERS-C
- 2=5/16X1 BOLTS-D
- 2=5/16 LOCK NUTS-E
- 4=5/16 SAE WASHERS-F



**THIS PLATE IS DESIGNED TO FIT THE RAMSEY 2500LB AND ALSO THE WARN 2000LB , 2500LB WINCHES.**

**THE WINCH WILL HAVE IT'S OWN HARDWARE TO MOUNT THE WINCH AND THE ROLLER FAIRLEAD TO THE PLATE.**

RAMSEY'S WINCH IS SUPPLIED WITH A ROLLER FAIRLEAD. THE WARN WILL COME WITH A HAWSE FAIRLEAD. THIS DEPENDS ON THE WINCH THAT IS PURCHASED. BOTH THE ROLLER OR HAWSE FAIRLEAD WILL MOUNT IN THAT SPECIFIC POSITION.

# 298016-R60

2002 SUZUKI EIGER 400 AUTO&STAND.

**THESE U-BOLTS WILL BOLT TO THE FRAME ONCE THE PLATE IS IN PLACE.**

IF THE HAWSE FAIRLEAD FROM WARN IS USED IN PLACE OF THE ROLLER FAIRLEAD USE THE BOLTS AND NUTS THAT OR ON THE HAWSE.

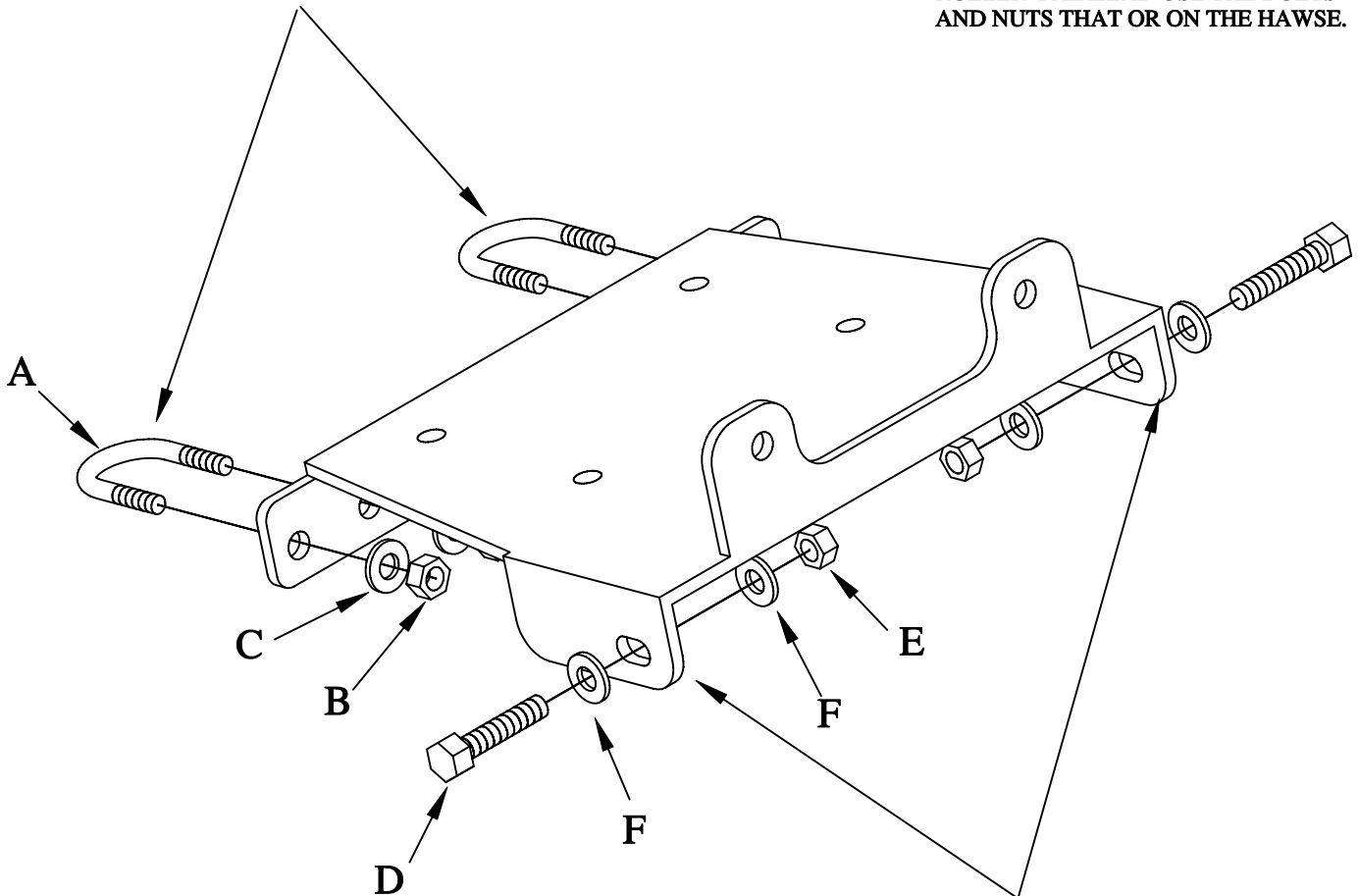

IF THE WARN RT25 IS USED MUST USE THE METRIC BOLTS THAT ARE SUPPLIED WITH THE HARDWARE IN THE BAG WITH THE WINCH. THESE BOLTS ARE USED TO MOUNT THE WIINCH TO THE PLATE.

**THESE EARS WILL BOLTS TO THE TABS THAT ARE WELDED ON TO THE FRAME BEHIND THE PLASTIC BUMPER IN FRONT OF ATV.**